

CHADSWORTH COLUMNS

FIXED MOUNTING SHUTTERS – INSTALLATION

FIXED MOUNT APPLICATIONS

The following components are included for Fixed Mount Applications.



(4) Polycarbonate mounting brackets (slotted)

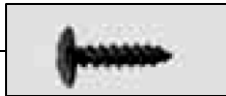

(8) #10 x 3/4" Stainless Steel Mounting Screws



(1) 0.5 oz. Tube All-Weather Silicone Caulk



(8) #10 x 2" Stainless Steel Mounting Screws

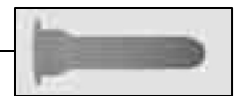

(8) Alligator Wall Anchors

1. Locate Lower Bracket

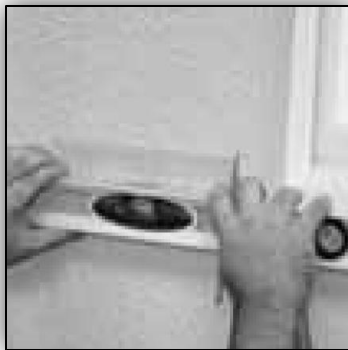

Locate and position the mounting bracket next to the lower side of the window opening. The bracket is approximately 1" narrower than the shutter panel, which will leave 1/2" between window opening and the end of the mounting bracket. Using a level to verify that the mounting bracket is located correctly, mark the position of the two slots on the wall. The slots in the mounting bracket will allow for some minor adjustment in the vertical position.

2. Drill 1/4" hole & install anchor into walls.



With the slots properly marked on the wall, drill a 1/4" diameter hole 2" in depth at the desired location along the marked slots. In each of the 1/4" holes, place one of the alligator wall anchors. These anchors are suitable for mounting into concrete, aerated concrete, brick, masonry, stone, cinderblock, stucco and wood. Gently tap the head of the anchor until it is flush with the wall.

www.COLUMNS.com

CHADSWORTH INCORPORATED

277 NORTH FRONT STREET • HISTORIC WILMINGTON, NC 28401 • PHONE: 1.800.486.2118 • FACSIMILE: 1.910.763.3191 • E-MAIL: sales@columns.com

FIXED MOUNTING SHUTTERS – INSTALLATION

3. Secure Bracket Into Wall at Desired Height with #10 x 2" screw.

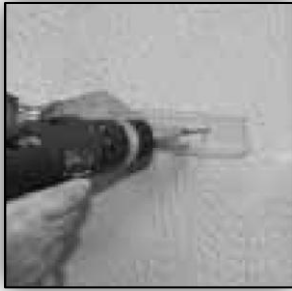

Place the bracket up against the wall and locate the anchors through the mounting slots. Drive the 2" screw through the slot and into the alligator wall anchor. The anchor will expand in the wall and is not capable of coming out. However, the anchor may be reused if adjustment of the screw depth is necessary during the initial installation. Repeat this step to drive a second screw through the second slot. Make sure the bracket and mounting screws are secure onto the wall.

4. Locate Top Bracket and Repeat Steps 2 and 3 to Mount



Place the shutter on the lower bracket and stabilize so it cannot tip off. Take the second mounting bracket and locate the correct position at the top of the shutter panel by scribing a line to locate the height. Remove the shutter panel carefully. Place the bracket on the wall and mark the two slots in the desired location. Repeat steps #2 & #3 to complete the installation of the mounting bracket.

NOTE: If your shutter is longer than 48", you will need to install side brackets for additional support. See Page 4.

5. Measure & Drill 9/64" Pilot Holes Into Shutter for #10 x 3/4" Screw.



Place the shutter panel up against the wall in the desired position. The lower mounting bracket will support the weight, but be sure to stabilize the shutter panel so it does not tip off. Mark the location of the holes in the brackets to the top and bottom ends of the shutter. Remove the shutter from the wall and drill a 9/64" diameter hole 1" deep into the ends of the shutter in the 4 marked locations. Make sure to drill the holes perpendicular to the shutter so as not to break through the surface of the shutter.

6. Place Silicone on Threads of #10 x 3/4" Screws.



Take each of the 3/4" mounting screws and spread a bead of all-weather silicone caulk along the threads. This will provide a barrier between the mounting holes and the interior of the shutter panel.

www.COLUMNS.com

CHADSWORTH INCORPORATED

277 NORTH FRONT STREET • HISTORIC WILMINGTON, NC 28401 • PHONE: 1.800.486.2118 • FACSIMILE: 1.910.763.3191 • E-MAIL: sales@columns.com

FIXED MOUNTING SHUTTERS – INSTALLATION

7. Drive #10 x 3/4" Screw Into Shutter.



Drive the 3/4" mounting screw, with silicone on the threads, into the pre-drilled pilot hole until the screw is snug. Make sure not to over-tighten the mounting screw, which may cause the material to strip out. Repeat this for each of the mounting screws, two per mounting bracket. The shutter panel is now properly mounted. Repeat steps 1-7 for the second shutter.

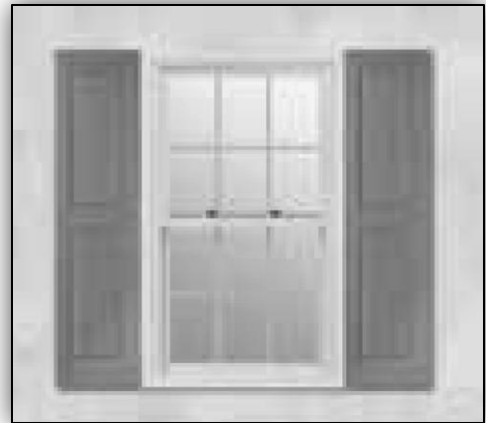

You have successfully mounted a pair of shutters!

FIXED MOUNT APPLICATIONS

The following components are included for Fixed Mount Applications.

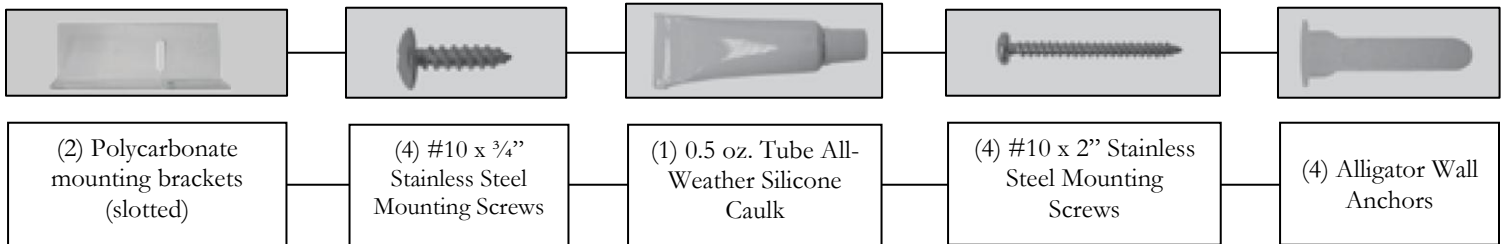

NOTE: Installation of side brackets of additional support. For shutters longer than 48".

www.COLUMNS.com

CHADSWORTH INCORPORATED

277 NORTH FRONT STREET • HISTORIC WILMINGTON, NC 28401 • PHONE: 1.800.486.2118 • FACSIMILE: 1.910.763.3191 • E-MAIL: sales@columns.com

FIXED MOUNTING SHUTTERS – INSTALLATION

1. Locate the Center



Find the center of the shutter and place a mark.

2. Position Bracket on Wall

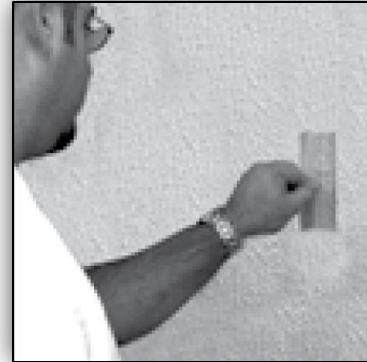

Align your 4 1/2" bracket to the center of the shutter and place your shutter between the upper and lower brackets on the wall. Be sure to stabilize the shutter so it does not tip off. Mark the outside edge of the bracket. With side bracket remaining on the wall, remove shutter and mark slots on bracket. **Note:** This is performed on both sides.

3. Drill 1/4" Hole & Install Anchor Into Wall



With the slots properly marked on the wall drill a 1/4" diameter hole 2" in depth at the desired location along the marked slots. In each of the 1/4" holes, place one of the alligator wall anchors. Gently tap the head of the anchor until it is flush with the wall.

4. Secure Bracket Into Wall at Desired Height with #10 x 2" Screw



Place the bracket up against the wall and locate the anchors through the mounting slots. Drive the 2" screw through the slot and into the alligator wall anchor. The anchor will expand in the wall and is not capable of coming out. However, the anchor may be reused if adjustment of the screw depth is necessary during the initial installation. Make sure the bracket and mounting screw are secure onto the wall.

www.COLUMNS.com

CHADSWORTH INCORPORATED

277 NORTH FRONT STREET • HISTORIC WILMINGTON, NC 28401 • PHONE: 1.800.486.2118 • FACSIMILE: 1.910.763.3191 • E-MAIL: sales@columns.com

FIXED MOUNTING SHUTTERS – INSTALLATION

5. Measure and Drill 9/64" Pilot Holes Into Shutter for #10 x 3/4" Screw



Place the shutter panel up against the wall in the desired position. The lower mounting bracket will support the weight, but be sure to stabilize the shutter panel so it does not tip off. Mark the location of the holes in the side bracket. Remove the shutter from the wall and drill a 9/64" diameter hole 1" deep into the side of the shutter in the 3 marked locations.

6. Place Silicone on Threads of #10 x 3/4" Screws



Take each of the 3/4" mounting screws and spread a bead of all-weather silicone caulk along the threads. This will provide a barrier between the mounting holes and the interior of the shutter panel.

7. Drive #10 x 3/4" Screws Into Shutter



Drive the 3/4" mounting screw, with silicone on the threads, into the pre-drilled pilot hole until the screw is snug. Make sure not to over-tighten the mounting screw, which may cause the material to strip out. The shutter panel is now properly mounted. Repeat steps 1-7 for the second shutter.



You have successfully side mounted a pair of shutters!

www.COLUMNS.com

CHADSWORTH INCORPORATED

277 NORTH FRONT STREET • HISTORIC WILMINGTON, NC 28401 • PHONE: 1.800.486.2118 • FACSIMILE: 1.910.763.3191 • E-MAIL: sales@columns.com